

TOWN OF PITTSBORO APPROVED FOR CONSTRUCTION			
	BY	DATE	PERMIT #
WATER (PW)(NCDENR)	N/A		
SEWER (PW)(NCDENR)	N/A		
COUNTY FLOW ACC.	N/A		
STREET (TOWN)			
DRIVEWAY (NCDOT)	N/A		
ENCROACHMENT (NCDOT)			
DRAINAGE (PW)			
EROSION CONTROL (PW)			
PLANNING/ZONING (TOWN)			
FIRE (TOWN)	N/A		

TIP NO. C-5551
WBS ELEMENT 51021.3.1

CONSTRUCTION DRAWINGS FOR US 64 SIDEWALK EXTENSION

5' CONCRETE SIDEWALK ALONG
US 64 (EAST STREET)
TOWN OF PITTSBORO, CHATHAM COUNTY
NORTH CAROLINA
JULY 2, 2014

SHEET INDEX

TITLE SHEET	C-1
PLAN & PROFILE STATION 0+00 - 7+50	P-1
PLAN & PROFILE STATION 7+50 - 16+50	P-2
PLAN & PROFILE STATION 16+50 - 22+50	P-3
DETAILS	D-1
DETAILS	D-2
EROSION CONTROL DETAILS	D-3

GENERAL NOTES:

- CONSTRUCTION ON THIS PROJECT SHALL BE IN ACCORDANCE WITH THE TOWN OF PITTSBORO STANDARD DETAILS, CODE OF ORDINANCES AND STANDARD SPECIFICATIONS AS WELL AS THE 2012 NCDOT ROADWAY STANDARD DRAWINGS AND STANDARD SPECIFICATIONS FOR ROADS AND STRUCTURES.
- THE GRADE LINES DENOTE THE FINISHED ELEVATIONS OF THE PROPOSED SURFACE. GRADE LINES MAY BE ADJUSTED AT THEIR BEGINNING, ENDING AND AT STRUCTURES AS DIRECTED BY THE ENGINEER IN ORDER TO PROVIDE A PROPER TIE-IN. CONTRACTOR SHALL FIELD VERIFY ALL PROPOSED INVERTS, FFE'S AND FINISHED SURFACES TO ENSURE THAT MINIMUM SLOPE & COVER REQUIREMENTS ARE PROVIDED PRIOR TO INSTALLATION OF REFERENCED ITEMS.
- UNDERGROUND UTILITIES MAY EXIST ON, ALONG OR WITHIN CONFLICT OF THIS PROJECT. THE CONTRACTOR IS RESPONSIBLE FOR CONTACTING NC-ONE-CALL OR THE APPROPRIATE UTILITY COMPANIES PRIOR TO ANY EXCAVATION.
- THE EARTHWORK ON THIS PLAN DOES NOT NECESSARILY BALANCE; OFFSITE BORROW OR WASTE MAY BE REQUIRED.
- ALL PIPE INVERTS TO BE VERIFIED IN THE FIELD PRIOR TO CONSTRUCTING GRAVITY SYSTEMS AND SHALL BE ADJUSTED BY THE ENGINEER IF NECESSARY.
- ALL CONCRETE PIPE SHALL BE REINFORCED CLASS III.
- THE CONTRACTOR SHALL PERFORM ALL CONSTRUCTION IN ACCORDANCE WITH LOCAL CITY, COUNTY AND STATE BUILDING CODES.
- THE CONTRACTOR SHALL BE FULLY RESPONSIBLE FOR THE DEMOLITION OF ALL EXISTING ON SITE ITEMS, ABOVE AND BELOW GROUND. THE CONTRACTOR IS ALSO RESPONSIBLE FOR REMOVAL OF ALL WASTE RESULTING FROM DEMOLITION, AS WELL AS GRADING AND FILLING OF ALL DEPRESSIONS TO INSURE THE SITE REMAINS AESTHETICALLY ACCEPTABLE.
- THE CONTRACTOR SHALL OBSERVE ALL REQUIRED SAFETY PRECAUTIONS IN THE PERFORMANCE OF ALL WORK IN ACCORDANCE WITH OSHA.
- THE CONTRACTOR SHALL GRADE, SEED AND SOD OR OTHERWISE PROVIDE TEMPORARY AND PERMANENT STABILIZATION OF ALL DISTURBED AREAS, ESPECIALLY SLOPES. SEE EROSION CONTROL INSTRUCTIONS, IF APPLICABLE.
- WORK WITHIN PUBLIC RIGHT-OF-WAYS SHALL BE IN ACCORDANCE WITH ALL STATE AND LOCAL REQUIREMENTS, NOTIFICATIONS, STANDARDS AND POLICIES.
- ANY SUBSTITUTIONS, CHANGES, OR MODIFICATIONS SHALL BE APPROVED BY THE PROJECT ENGINEER, PLANNING DEPARTMENT STAFF, AND DEVELOPER PRIOR TO INSTALLATION/CONSTRUCTION OF CORRESPONDING ITEMS.
- PRIOR TO BEGINNING CONSTRUCTION, THE CONTRACTOR SHALL BE RESPONSIBLE FOR ACQUIRING ALL PERMITS NECESSARY FOR CONSTRUCTION. THE CONTRACTOR SHALL READ ALL PERMITS AND ENSURE THAT CONSTRUCTION COMPLIES WITH THE PERMITS. REQUIRED PERMITS AND REVIEWS MAY INCLUDE, BUT ARE NOT LIMITED TO: CITY/COUNTY APPROVALS/PERMITS, CITY FIRE DEPARTMENT, SOLID WASTE REVIEWS, NCDOT PERMITS, DRIVEWAY PERMITS, RIGHT OF WAY ENCROACHMENT AGREEMENTS, SOIL AND EROSION CONTROL PERMITS, NCDENR PERMITS, WATER PERMITS, SEWER PERMITS, ENVIRONMENTAL PERMITS, WETLAND DISTURBANCE PERMITS, STREAM CROSSING PERMITS, POWER EASEMENT ENCROACHMENT AGREEMENTS, USACE/DWQ PERMITS, STORMWATER PERMITS, ZONING APPROVAL, AND BUILDING CODE APPROVALS/PERMITS. IF THE CONTRACTOR HAS QUESTIONS ABOUT PERMIT LANGUAGE, OR THE NEED FOR A PERMIT, HE MUST CONTACT THE DEVELOPER AND THE ENGINEER PRIOR TO BEGINNING CONSTRUCTION.

OWNER / DEVELOPER CONTACT:

FREDRIC T. ROYAL, PE, CFM
TOWN ENGINEER
TOWN OF PITTSBORO, NC 27312
(919) 542-2063 OFFICE
(919) 542-2310 FAX
FROYAL@PITTSBORONC.GOV

SURVEYOR CONTACT:

WILLIAM MCCARTHY
SUMMIT DESIGN & ENGINEERING
504 MEADOWLAND DRIVE
HILLSBOROUGH, NC 27278
(919) 732-3883 (PHONE)
(919) 732-6676 (FAX)

CIVIL & SITE ENGINEER CONTACT:

CHAD ABBOTT
SUMMIT DESIGN & ENGINEERING SERVICES
504 MEADOWLAND DRIVE
HILLSBOROUGH, NC 27278
(919) 732-3883 (PHONE)
(919) 732-6676 (FAX)
CHAD.ABBOTT@SUMMITDE.NET

PUBLIC SERVICE CONTACTS:

WATER: TOWN OF PITTSBORO
CONTACT: JOHN POTEAT
635 EAST STREET
PITTSBORO, NC 27312
(919) 542-4621 EXT 23

SEWER: TOWN OF PITTSBORO
CONTACT: JOHN POTEAT
635 EAST STREET
PITTSBORO, NC 27312
(919) 542-4621 EXT 23

FIRE: PITTSBORO FIRE DEPARTMENT
CONTACT: DARYL GRIFFIN
PO BOX 573
PITTSBORO, NC 27312
(919) 542-4101

ELECTRIC: PROGRESS ENERGY CAROLINAS
(800) 452-2777

TELEPHONE: CENTURY LINK
(336)625-1006 OR (866) 304-6820

GAS: PSNC ENERGY
(877) 776-2427

STATE ROADWAYS: NCDOT

SOLID WASTE: WASTE INDUSTRIES
148 STONE PARK COURT
DURHAM, NC 27703
(919) 596-1363

PLANNING: TOWN OF PITTSBORO
CONTACT: STUART BASS
635 EAST STREET
PITTSBORO, NC 27312
(919) 542-4621 EXT 34

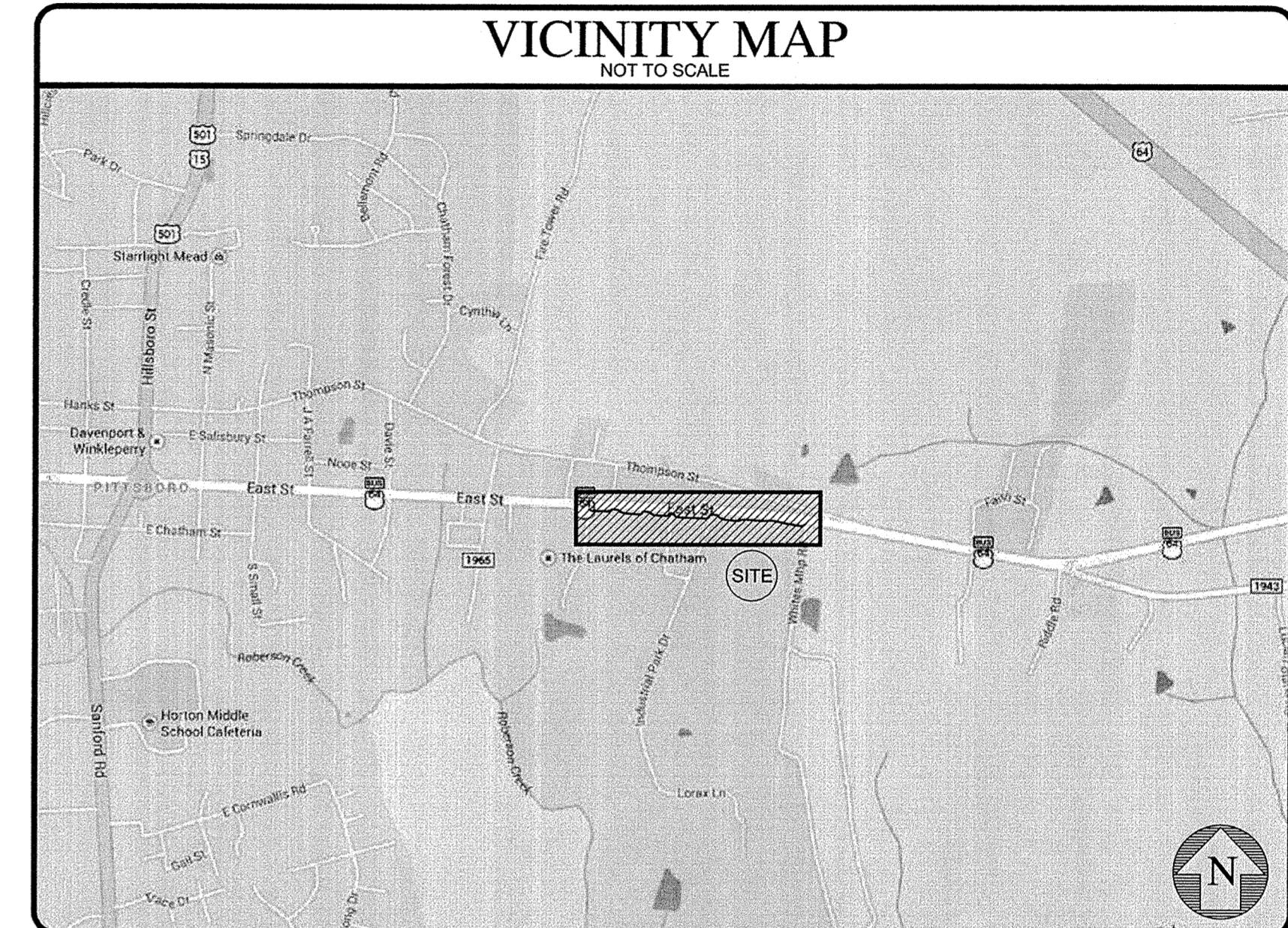

PAY ITEMS

LINE NO.	ITEM NUMBER	SECT	DESCRIPTION	QUANTITY	UNIT
1	0000100000-N	800	MOBILIZATION	1	LS
2	0000400000-N	801	CONSTRUCTION SURVEYING	1	LS
3	0000930000-E	SP	GENERIC MISCELLANEOUS ITEM, HANDRAIL	12	LF
4	0043000000-N	226	GRADING	1	LS
5	0366000000-E	310	15" RC PIPE CULVERTS, CLASS III	27	LF
6	0372000000-E	310	18" RC PIPE CULVERTS, CLASS III	223	LF
7	2286000000-N	840	MASONRY DRAINAGE STRUCTURE	3	EA
8	2352000000-N	840	FRAME WITH GRATE, STD 840.xx	3	EA
9	2570000000-N	SP	MODIFIED CONCRETE FLUME	1	EA
10	2591000000-E	848	4" CONCRETE SIDEWALK	1,171	SY
11	2600000000-N	SP	RETROFIT EXISTING CURB RAMP	1	EA
12	2605000000-N	848	CONCRETE CURB RAMP	3	EA
13	4457000000-N	1105	TEMPORARY TRAFFIC CONTROL	1	LS
14	4820000000-E	1205	PAINT PAVEMENT MARKING LINES (8")	368	LF
15	6000000000-E	1605	TEMPORARY SILT FENCE	2,010	LF
16	6006000000-E	1610	EROSION CONTROL STONE, CLASS A	50	TON
17	6009000000-E	1610	EROSION CONTROL STONE, CLASS B	24	TON
18	6012000000-E	1610	SEDIMENT CONTROL STONE	50	TON
19	6029000000-E	SP	SAFETY FENCE	2,020	LF
20	6042000000-E	1632	1/4" HARDWARE CLOTH	120.00	LF
21	6071010000-E	SP	WATTLE	70.00	LF
22	6071020000-E	SP	POLYACRYLAMIDE (PAM)	7.00	LBS
23	6084000000-E	1660	SEED & MULCHING	0.80	AC



SITE LOCATION MAP
NOT TO SCALE

DISTURBED AREA
0.9926 AC



Know what's below.
Call before you dig.

NO.	REVISIONS	DATE	BY
7			
6			
5			
4			
3			
2			
1			

COPYRIGHT © 2013
SUMMIT DESIGN AND
ENGINEERING SERVICES
DRAWING ABBOTT
ALL RIGHTS RESERVED. NO PART OF THIS DOCUMENT IS TO BE REPRODUCED OR TRANSMITTED IN ANY FORM OR BY ANY MEANS, ELECTRONIC OR MECHANICAL, INCLUDING PHOTOCOPYING, RECORDING, OR BY ANY INFORMATION STORAGE AND RETRIEVAL SYSTEM, WITHOUT THE WRITTEN PERMISSION OF SUMMIT DESIGN AND ENGINEERING SERVICES.
DRAWN BY: KSW
SCALE:

PROJECT ENGINEER/ARCHITECT
CEA
PROJECT MANAGER
CEA
DRAWN BY
KSW
SCALE



MODIFIED CONCRETE FLUME WITH CONCRETE OUTLET:

At locations shown in the plans, construct concrete flumes, concrete curb, and apron in accordance with the details in the plans. Use materials meeting the requirements of Section 825 of the 2012 Standard Specifications except that the concrete must be Class B or of higher compressive strength.

Each concrete flume, concrete curb, and apron completed and accepted will be paid at the contract unit price per each for Modified Concrete Flume. Such price and payment will be full compensation for all materials, labor, equipment, tools, removing and disposing of the temporary slope drains, and any other incidentals necessary to complete the work satisfactorily.

The concrete curb and ditch outside the pay limits of the apron will be measured and paid in accordance with Section 846 and 850 of the 2012 Standard Specifications.

Payment will be made under:

Pay Item Pay Unit Modified Concrete Flume Each

2 BAR HANDRAIL:

Description

Furnish and install 2 Bar Handrail at the location shown in the plans in accordance with the detail in the plans and as directed by the Engineer.

Measurement and Payment

2 Bar Handrail will be measured and paid for as the actual number of linear feet of handrail measured along the top of the handrail to the nearest 0.1 of a foot. Such price and payment will be full compensation for fabricating, furnishing, installing, painting and all incidentals necessary to satisfactorily install the 2 Bar Handrail.

Payment will be made under:

Pay Item Pay Unit 2 Bar Handrail Linear Foot

SUMMIT
DESIGN AND ENGINEERING SERVICES
Creatively Inspired - Technically Executed
License # 14-0339
504 Meadowland Drive, Suite 451
Hillsborough, NC 27278
Voice: (919) 732-3883 Fax: (919) 732-6676
www.summit-engineer.com

CONSTRUCTION DRAWINGS
US 64 SIDEWALK EXTENSION
PITTSBORO, NC
TITLE SHEET

PROJECT NO.

13-0258

DRAWING NAME:

13-0258_TS-1

SHEET NO.

C-1

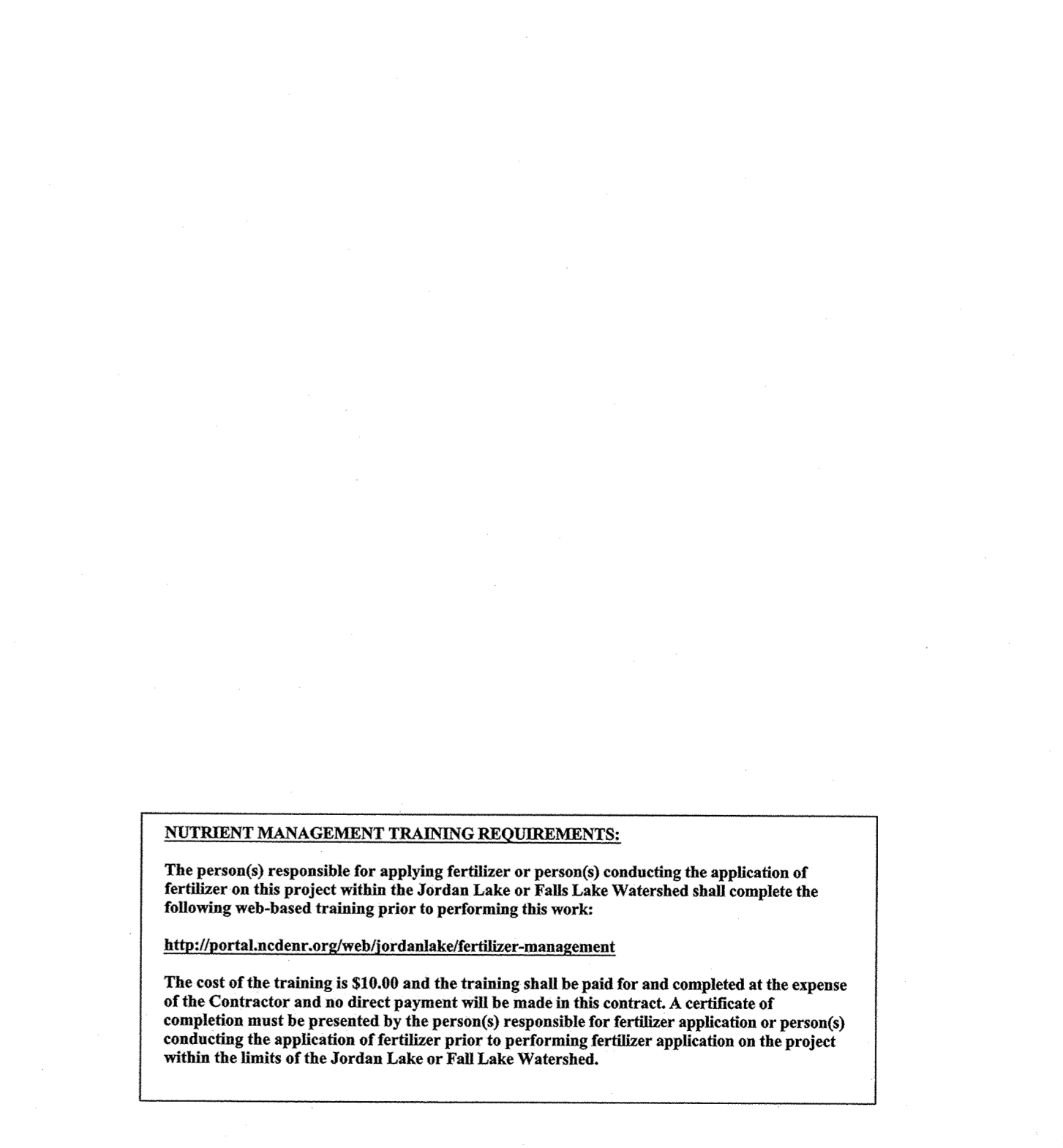
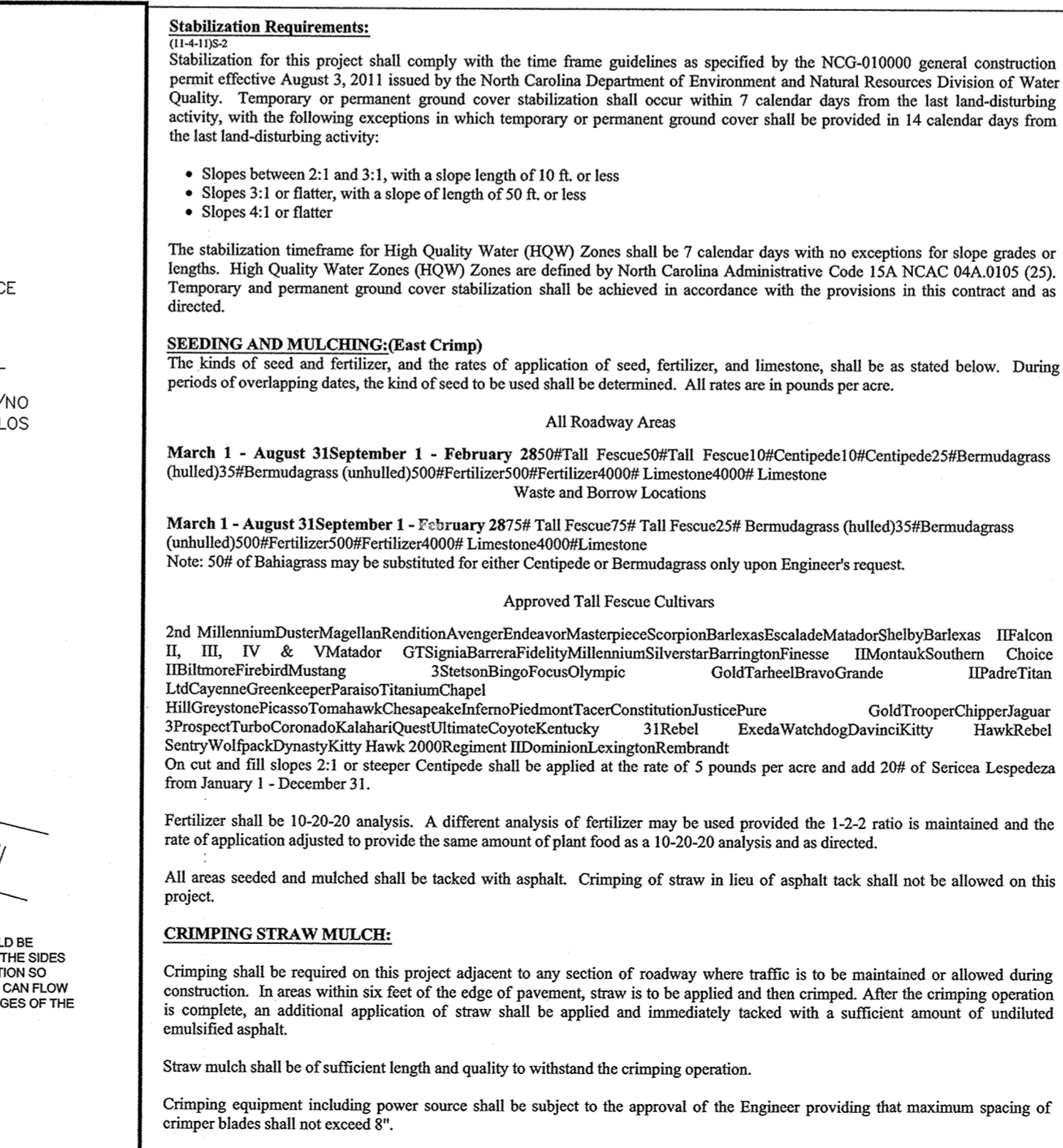
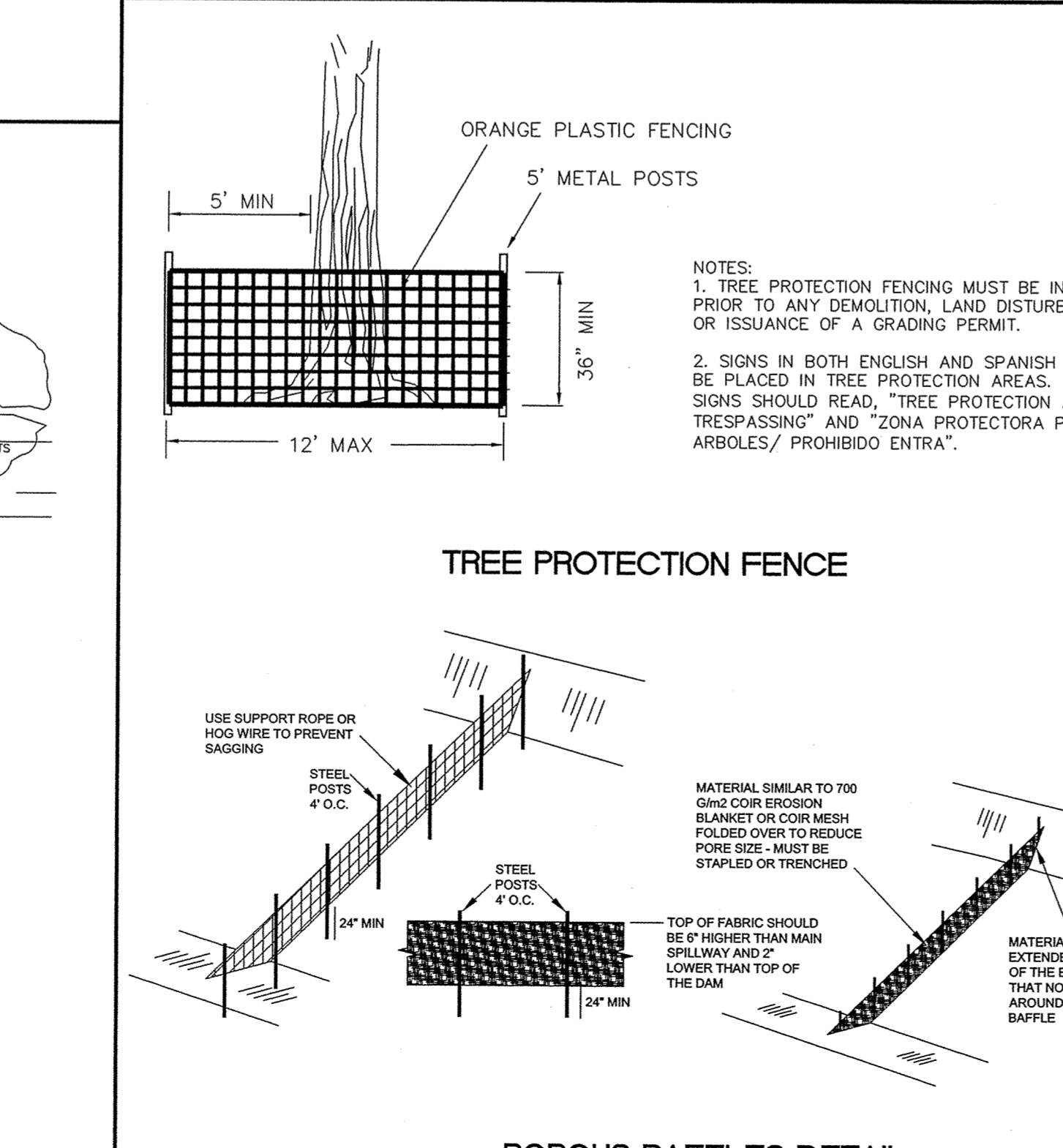
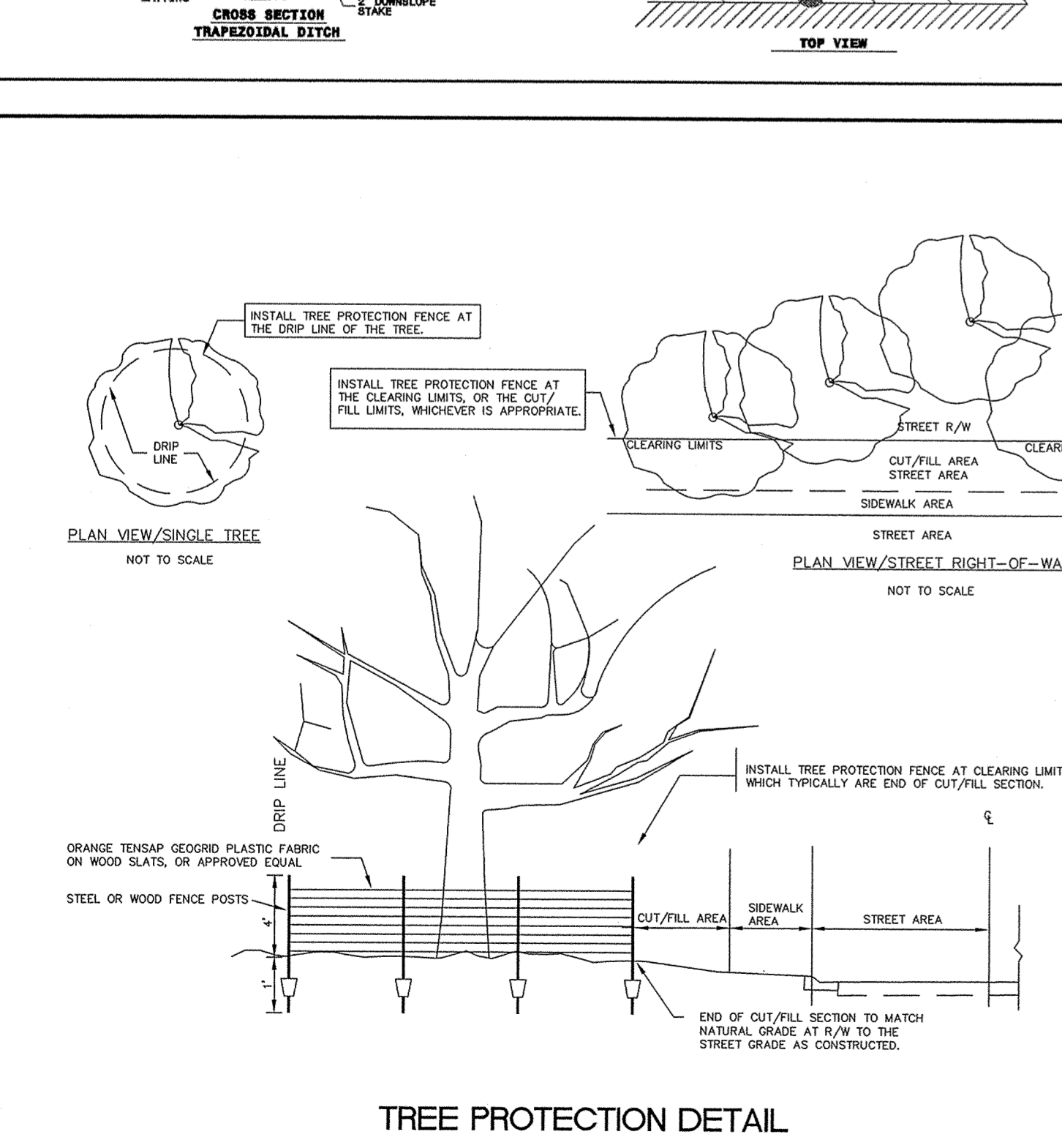
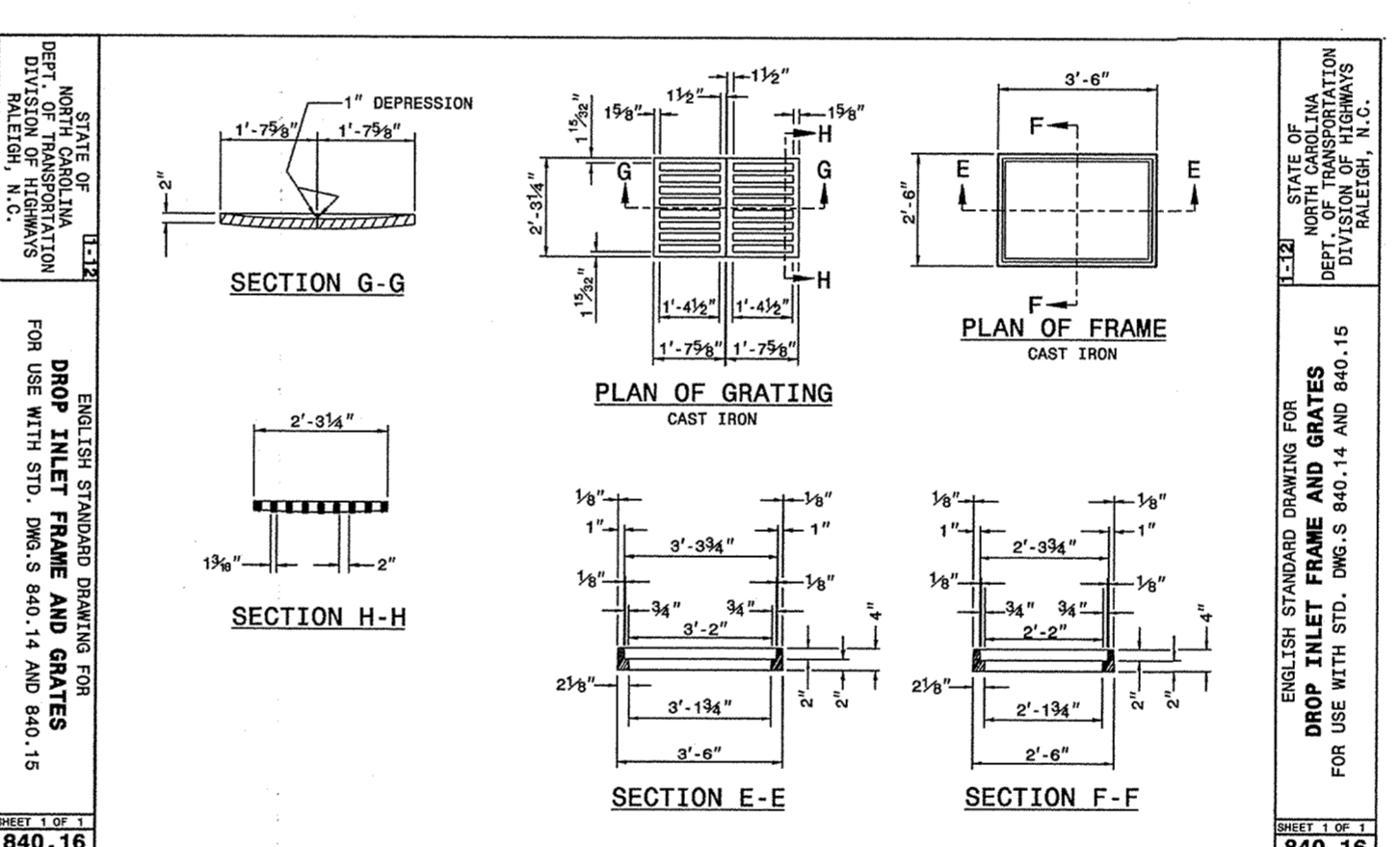
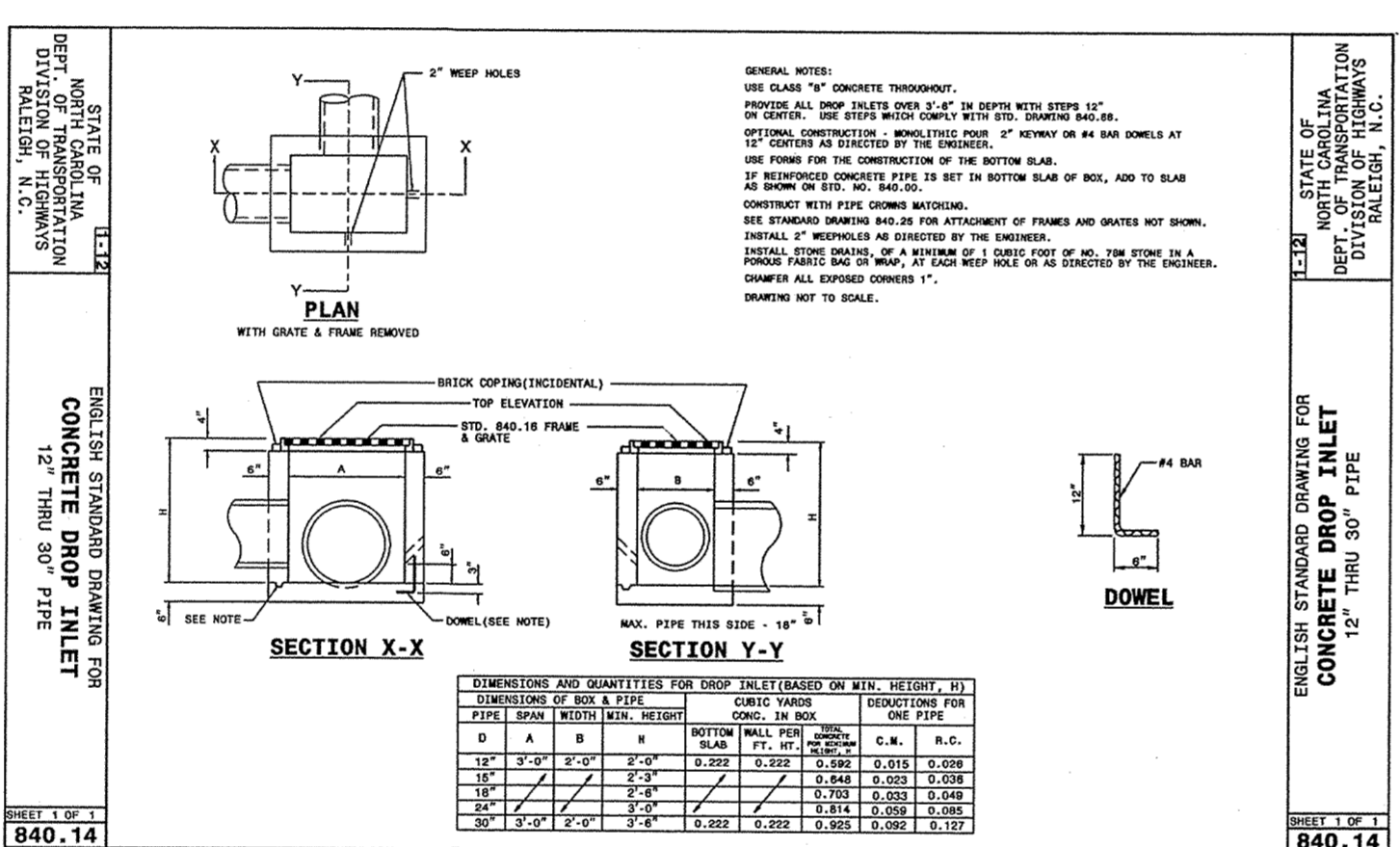
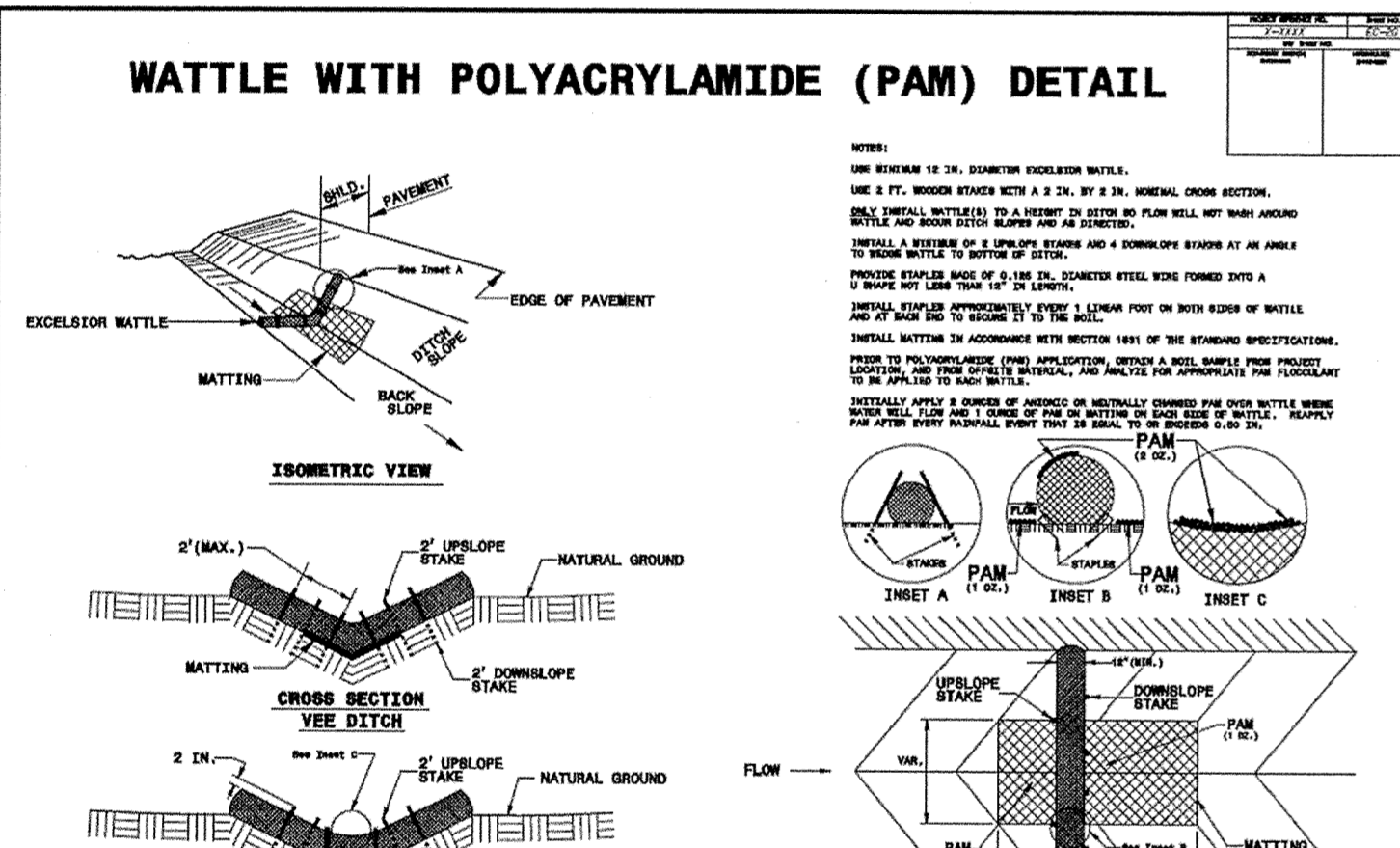
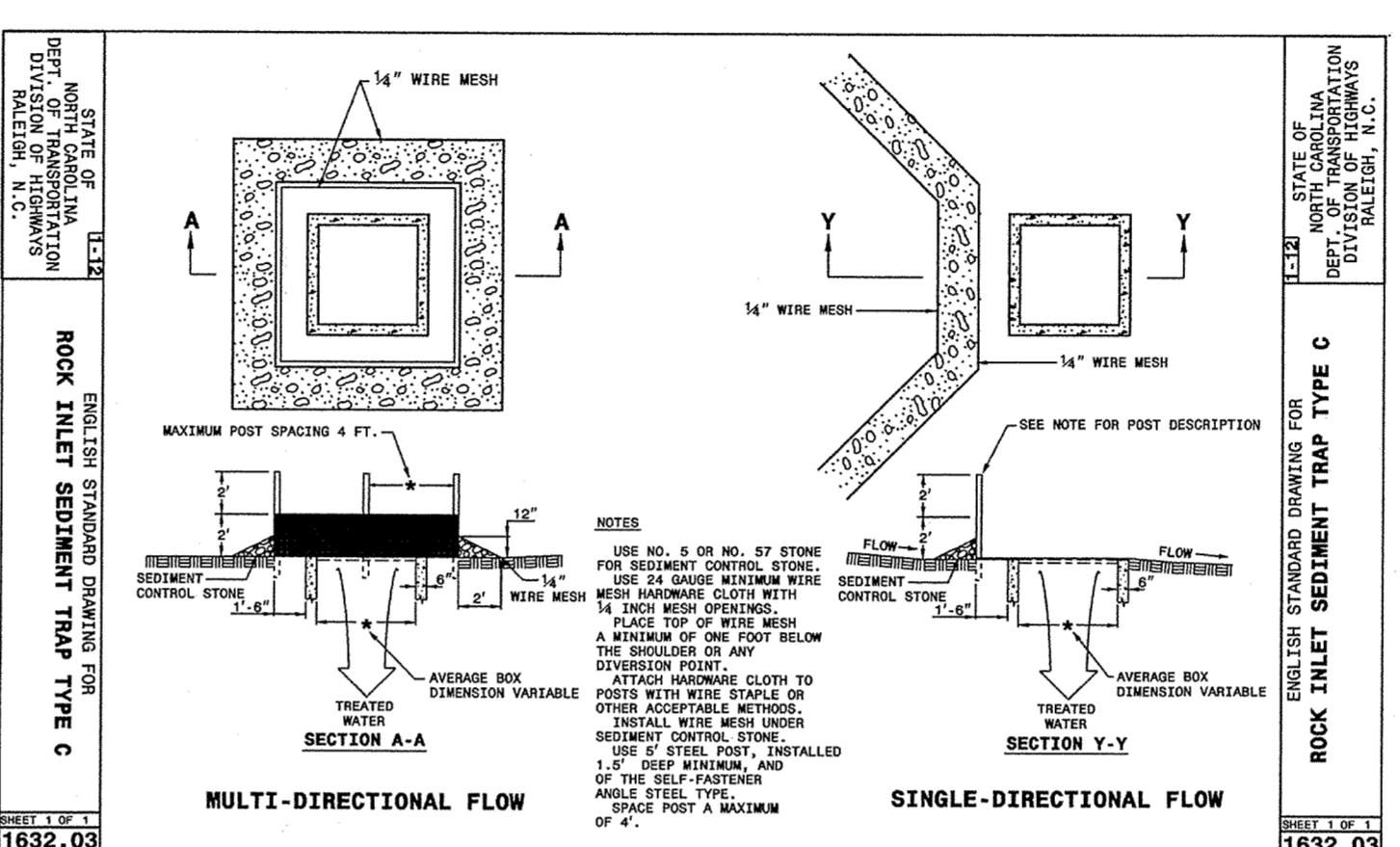
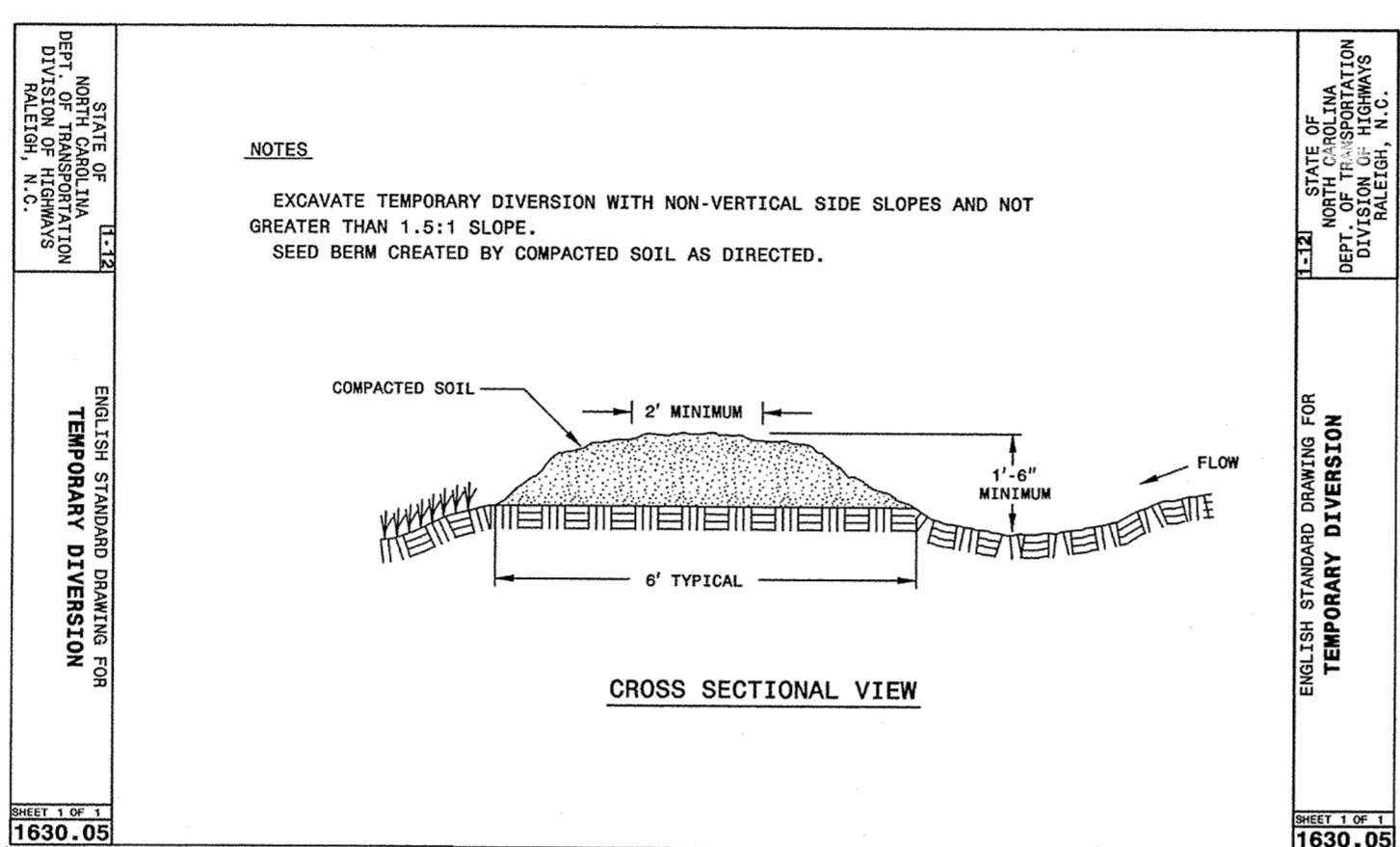
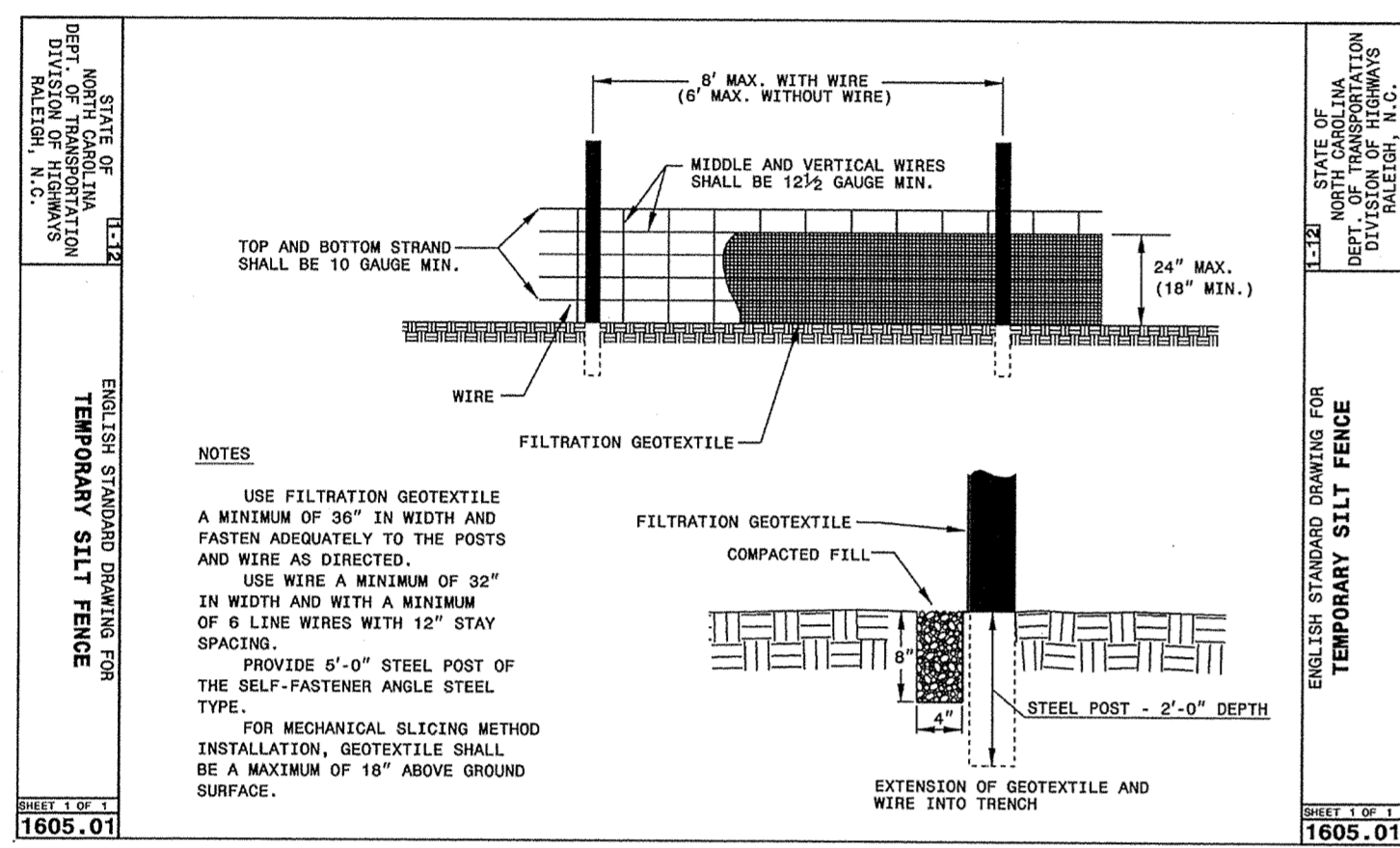
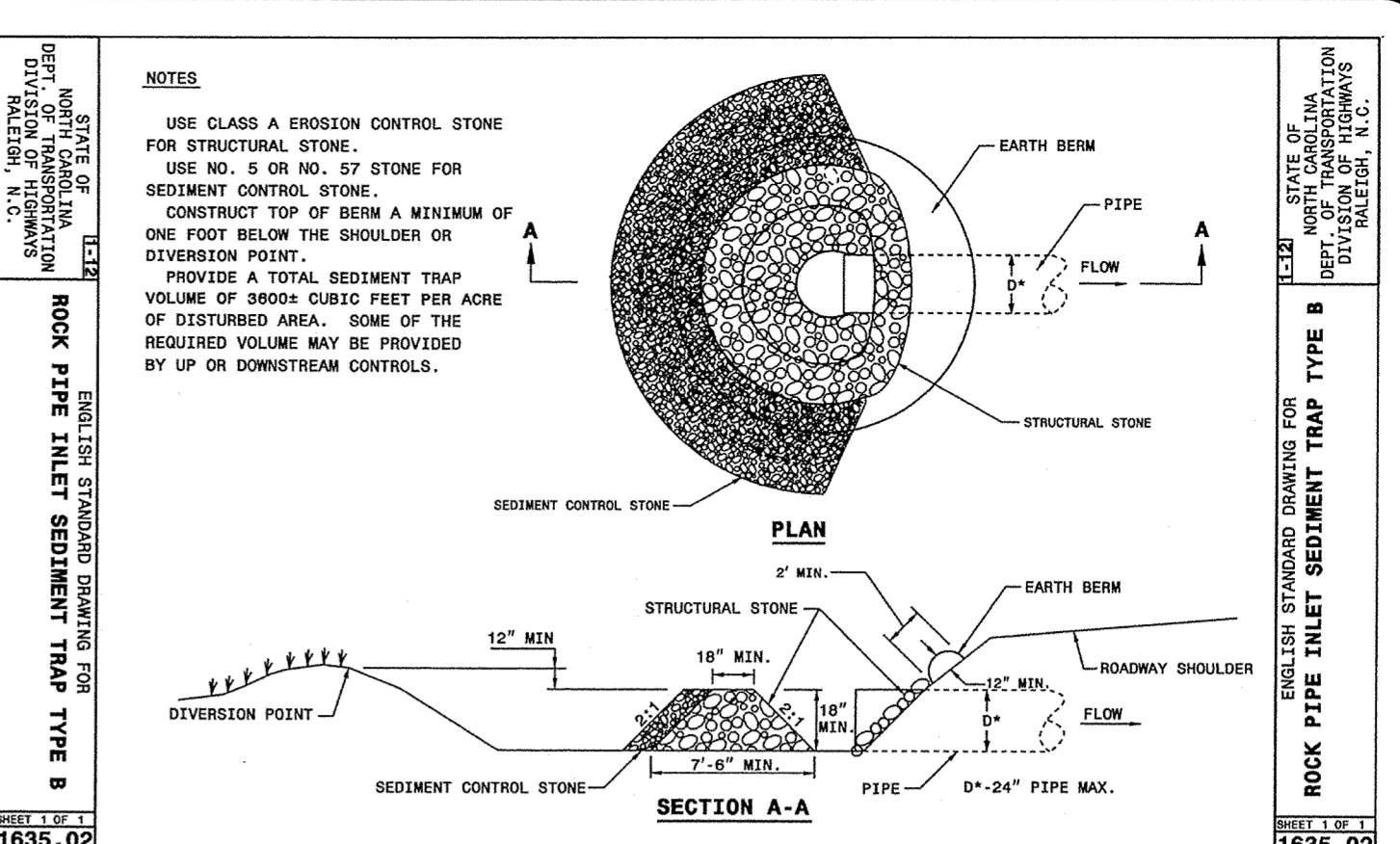
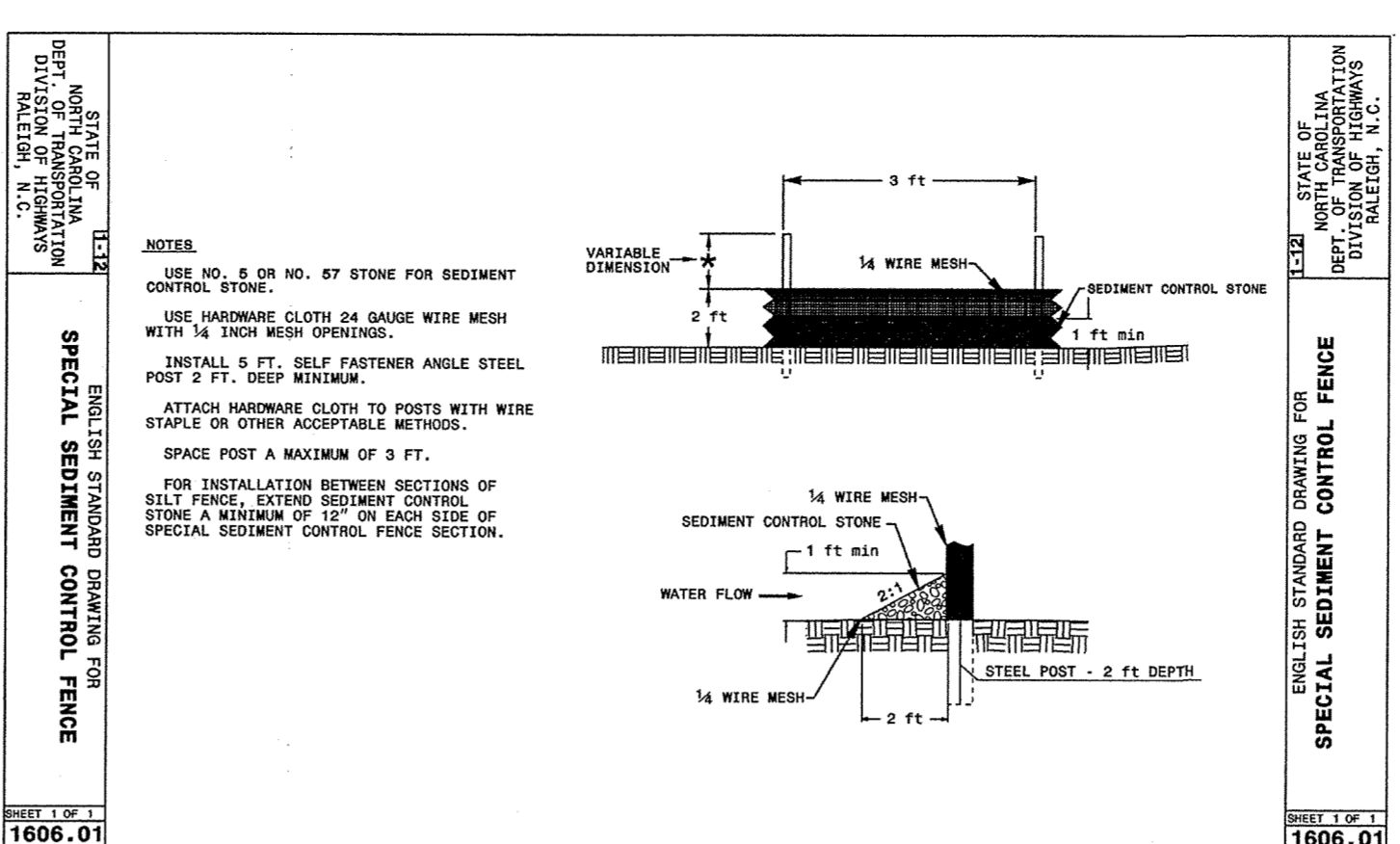
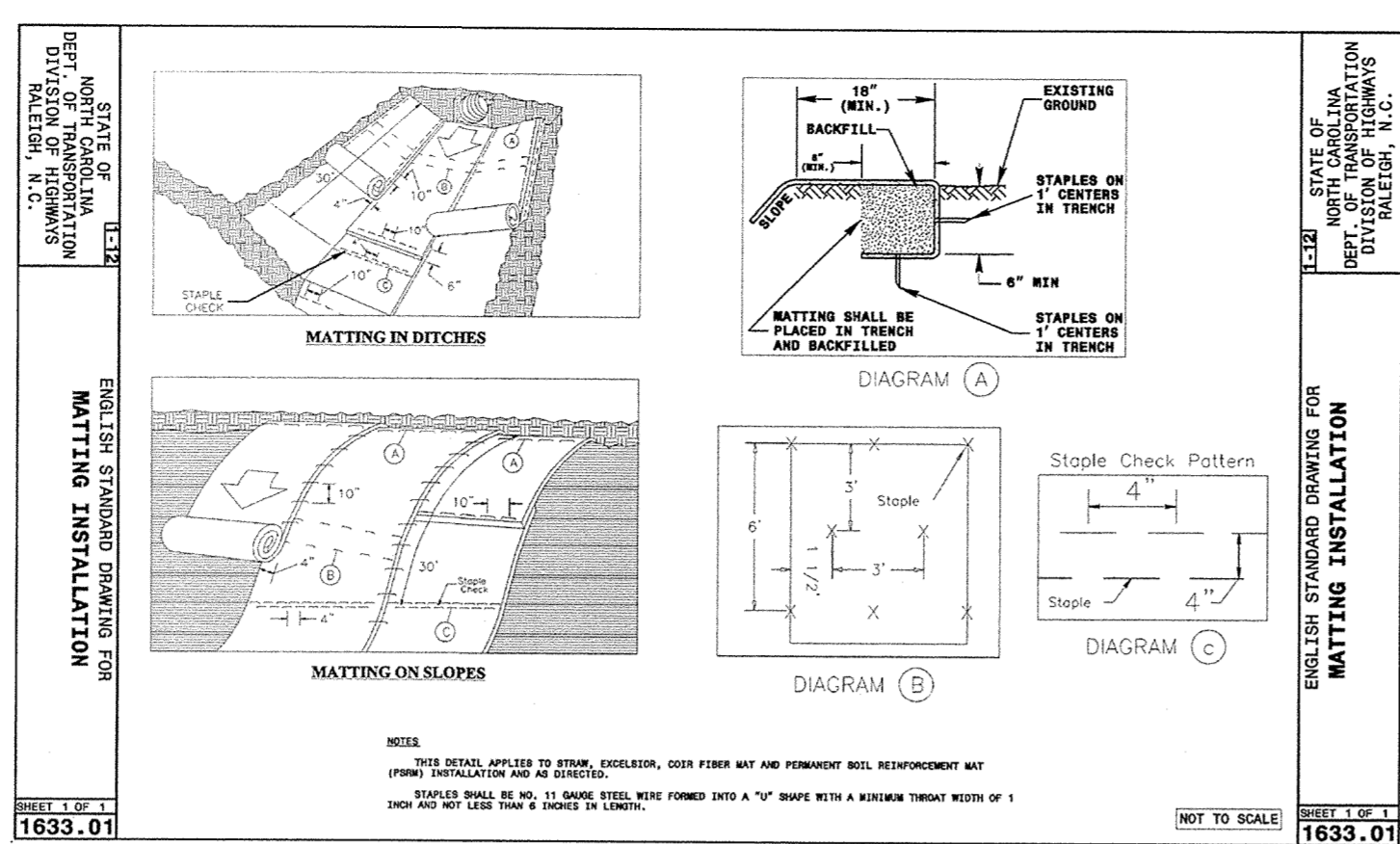
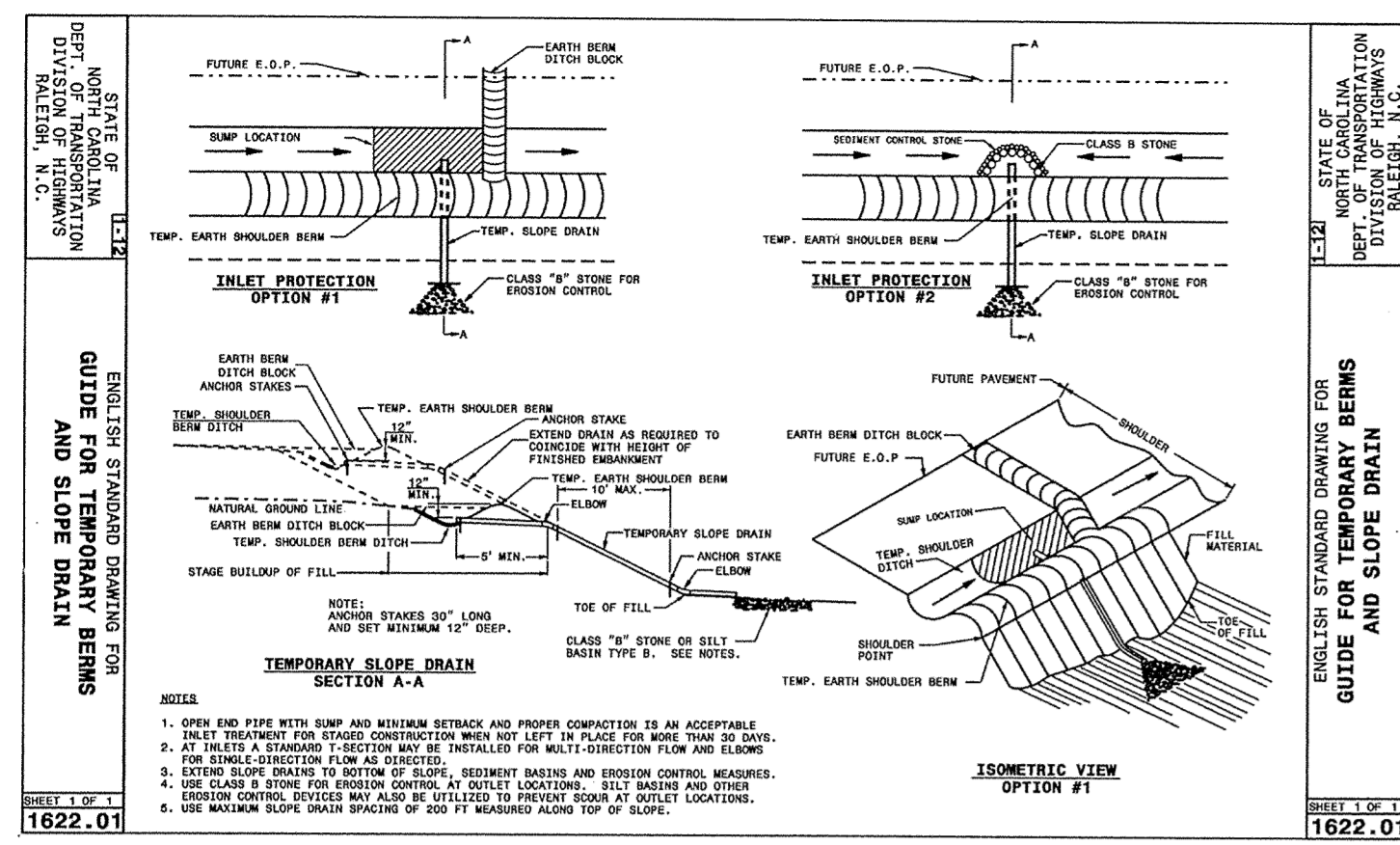

NO.	REVISIONS	DATE	BY
7			
6			
5			
4			
3			
2			
1			

COPYRIGHT © 2013
 DESIGN AND ENGINEERING SERVICES
 PROJECT MANAGER
 CEA
 DRAWN BY
 KSW
 SCALE

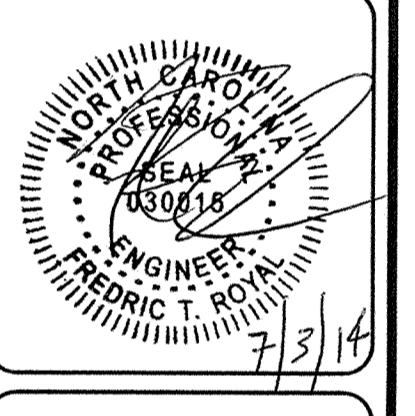

SUMMIT
 DESIGN AND ENGINEERING SERVICES
 Creatively Inspired - Technically Executed
 License # P-00388 Davis
 Hillsborough, NC 27278-6551
 Voice: (919) 732-3883 Fax: (919) 732-6676
 www.summitengineer.com

CONSTRUCTION DRAWINGS
US 64 SIDEWALK EXTENSION
 PITTSPORO, NC
EROSION CONTROL DETAILS

PROJECT NO.
13-0258
 DRAWING NO.
13-0258-D-1
 SHEET NO.
D-3